



40 Greystoke Lodge, London, W5 1EW

Set in the prestigious Greystoke Lodge, a prime residential development in the heart of Ealing close by to Hanger Hill Park is this very large studio apartment measuring close to 400 sq ft.

The property is stationed on the top floor (4th floor with lift) and comprises of a large reception/bedroom, great sized separate kitchen, family sized bathroom and has the added benefit of a share in the freehold and no onward chain. Off street parking can be sought with a permit through the management company.

- Large studio
- Purpose built
- Share of freehold
- No chain
- Close to transport links
- Touching 400 sq ft in size
- Separate kitchen
- Forth floor (top floor)
- Lift
- Large communal gardens

£230,000

Greystoke Lodge

Approximate Gross Internal Area
398 sq ft - 37 sq m

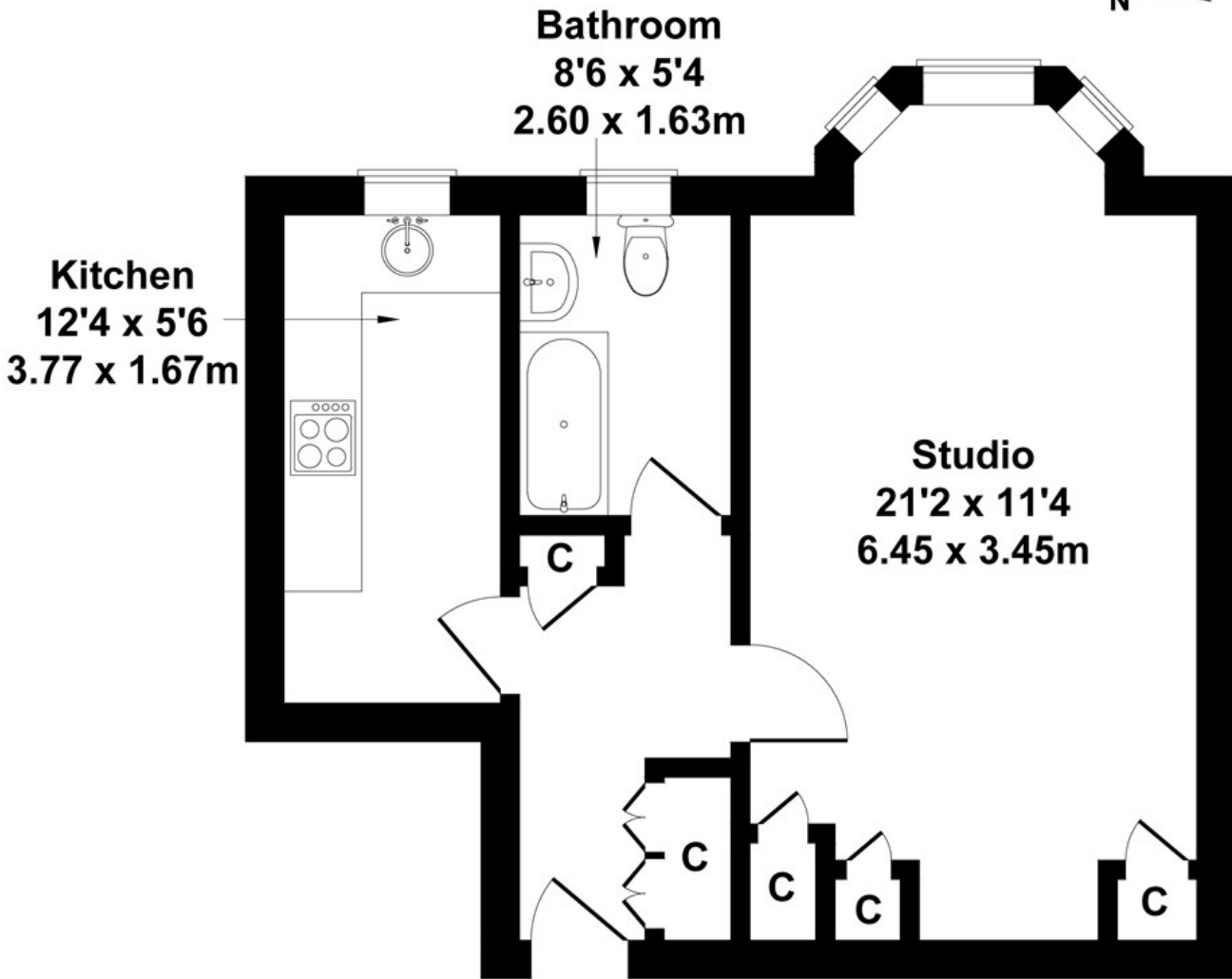
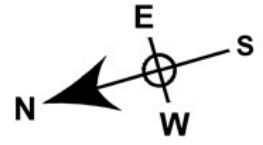

Forth FLOOR

Not to Scale. Produced by The Plan Portal 2023
For Illustrative Purposes Only.

Energy Efficiency Rating		
	Current	Potential
<i>Very energy efficient - lower running costs</i>		
(92 plus) A		
(81-91) B		
(69-80) C		
(55-68) D		
(39-54) E		
(21-38) F		
(1-20) G		
<i>Not energy efficient - higher running costs</i>		
England & Wales	EU Directive 2002/91/EC	